

Mobile original historic Polish Restaurant & Events Cabin

(Temporary structure with TÜV inspection record
and permission for erection)



Contact:
Ulf Buhlemann * Tel.: +49-172-311 50 58 * Email: buhlemann@t-online.de

Facts & Figures (1)

Place of origin: Poland, Iwierzycze

Age: approx. 90 years

Dismantled and converted to a restaurant & events cabin:

October – November 2011

Floor area:

- Ground-floor events area incl. stage + bar area: approximately 89 m²
- Storage and preparation area in loft: approximately 80 m²

Stage: approximately 20 m²

Capacity:

- Seating at tables for 6 and 4 people: seating approximately 65 people
- Theatre seating: up to 99 people

Bar area:

- Refrigerated counter (cabinet + 2 drawers, convection cooling) with 2 sinks
- Base unit
- Shelving
- Dishwasher
- Refrigerator
- Hand wash basin
- 30L hot water boiler
- Licensed premises under local municipal authority (restaurant operator's licence) at the current location.

Oven:

- Original metal oven/cooking range, approximately 1870
- Prefabricated chimney
- Wood and coal burning
- Chimney sweep's certification



Contact:

Ulf Buhlemann * Tel.: +49-172-311 50 58 * Email: buhlemann@t-online.de

Facts & Figures (2)



Construction:

- Original log house with saddleback roof
- (Bolted) steel-frame reinforcement on ground floor
- Ground-floor sides cut for transport and assembly purposes and connected using mounting profiles
- Roof covering: bitumen roofing felt



Dimensions:

- 7,50 m x 13,05 m
- Ridge height: approximately 6.7 m



Electrical system:

- Free-standing electrical distribution box in loft with meter
- Flexible cabling inside the cabin via rubber-sheathed cable with Schuko plugs
- Connection cable: 3 x 63 A, 240 V, heavy-duty rubber-sheathed cable, approx. 100 m long
- Detailed documentation available
- Simple, fast erection and dismantling possible without specialist companies



Approval + documentation:

- An inspection record (incl. structural analysis) and permission for erection from TÜV Rheinland Industrie Service GmbH is available.
- Permission for erection is valid until 01.11.2014 and can be extended until 01.11.2017.
- Plans and structural analyses are available.

Video Impression of erection of the cabin: <http://youtu.be/Q2zbe97saSE>

Contact:

Ulf Buhlemann * Tel.: +49-172-311 50 58 * Email: buhlemann@t-online.de

Facts & Figures (3)

Disassembly, assembly and transport:

- There are detailed specifications available for disassembly and assembly as well as transport (by road haulage) or container (by sea).
- There are various offers from specialist companies for disassembly, assembly + transport (by road haulage).

Current location + viewing:

- Germany, Berlin, Prenzlauer Allee 242 – 247, “Bötzow-Brauerei” site
- Flexible arrangements can be made for viewings by telephone appointment.



Scope of service:

- Sale of the mobile events cabin will be in its current, erected condition, as seen, including furniture.
- Plans, structural analysis and TÜV inspection record will be supplied to the purchaser.
- The purchaser is obliged to dismantle the cabin within an agreed period at his own expense. The aforementioned specifications and offers for dismantling, assembly and transport are purely for the purchaser's information and do not constitute part of the item being purchased.

Vendor:

SPIELTRIEB Theaterproduktionen und Veranstaltungen GmbH
Torstraße 138
D-10119 Berlin, Germany
Managing Director: Ulf Buhleemann
Mobile: +49-172-3115058
Email: buhleemann@t-online.de

Contact:

Ulf Buhleemann * Tel.: +49-172-311 50 58 * Email: buhleemann@t-online.de

Plans

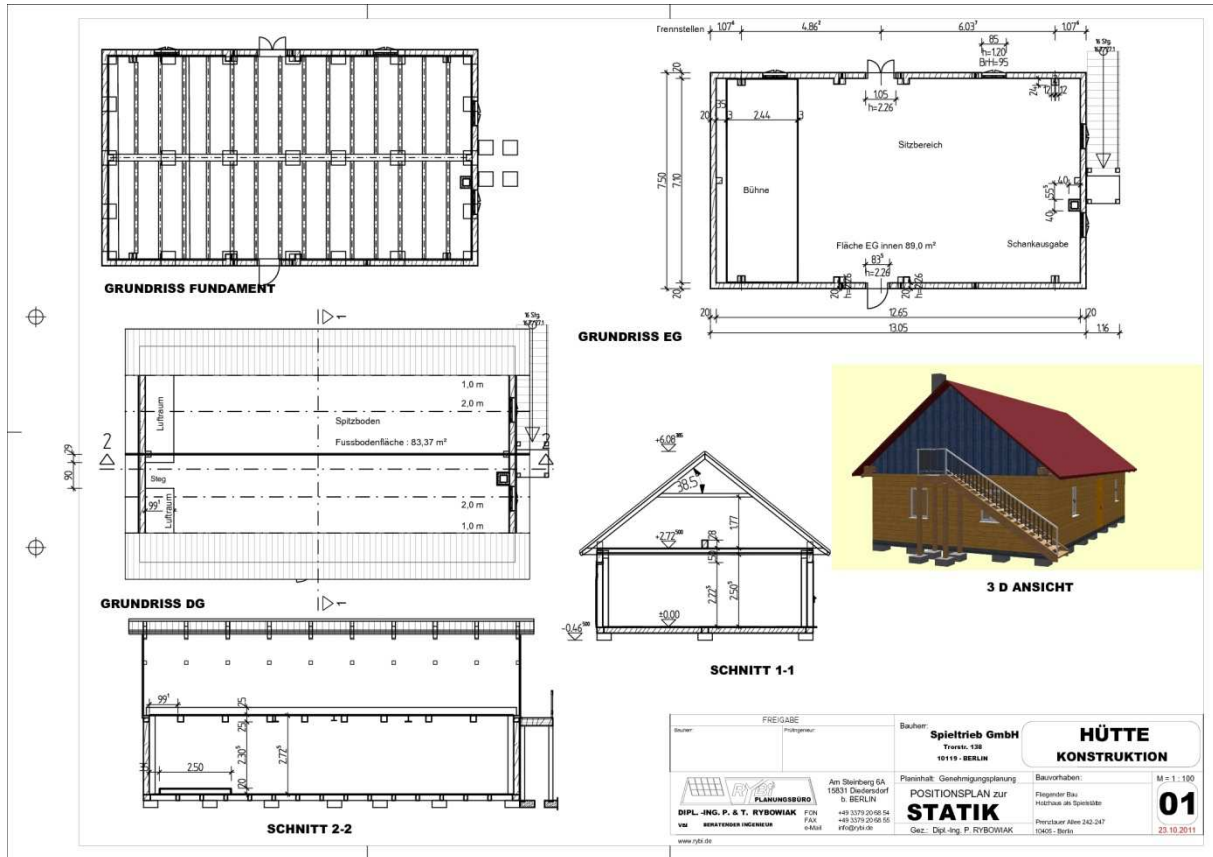

Key to above plans:

Grundriss = floor plan

EG = ground floor

DG = loft

Schnitt = cross-section

Ansicht = view

Contact:

Ulf Buhleemann * Tel.: +49-172-311 50 58 * Email: buhleemann@t-online.de

Photographic Impressions



Photographic Impressions



Photographic Impressions

